

Revisions	Date	No.

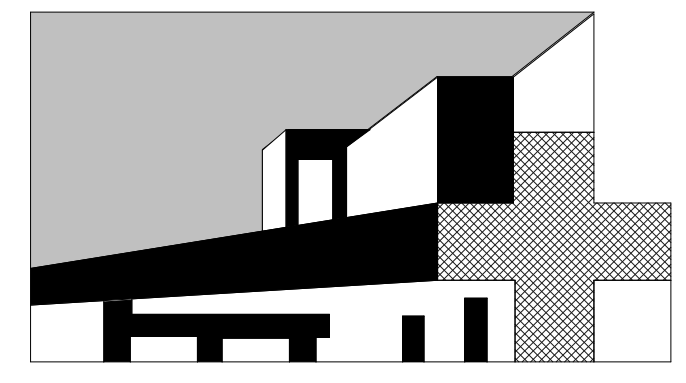

**CALVERT MEMORIAL HOSPITAL**  
100 HOSPITAL ROAD  
PRINCE FREDERICK, MARYLAND

**PATIENT TOWER  
ADDITION AND  
RENOVATIONS**

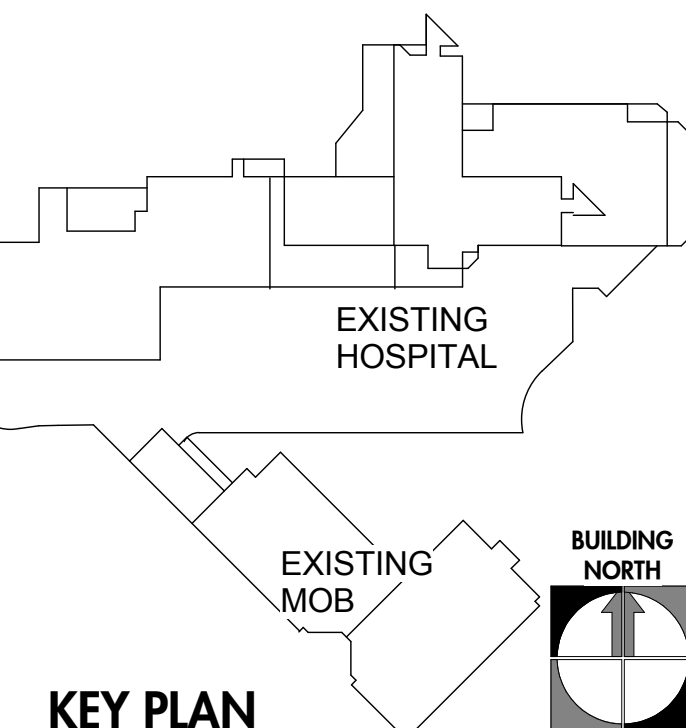

I certify that these documents were prepared or approved by me, and that I am a duly licensed architect under the laws of the State of Maryland.  
License Number: \_\_\_\_\_  
Expiration Date: \_\_\_\_\_

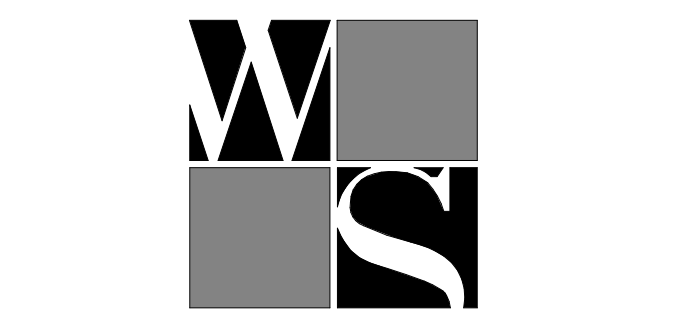

**WILMOT SANZ**  
ARCHITECTURE  
PLANNING  
18310 Montgomery Village Avenue  
Gaithersburg, Maryland 20879  
301-590-2900 (Fax) 301-590-8150

**NEW FIRST FLOOR  
PLAN - DEPT.**

Project Number 9411.72  
Scale 1/16" = 1'-0"  
Date October 5, 2015

Print Date/Stamp 9/28/2015 9:07:51 AM

Drawing No.: **A1-1E**  
SCHEMATIC DESIGN

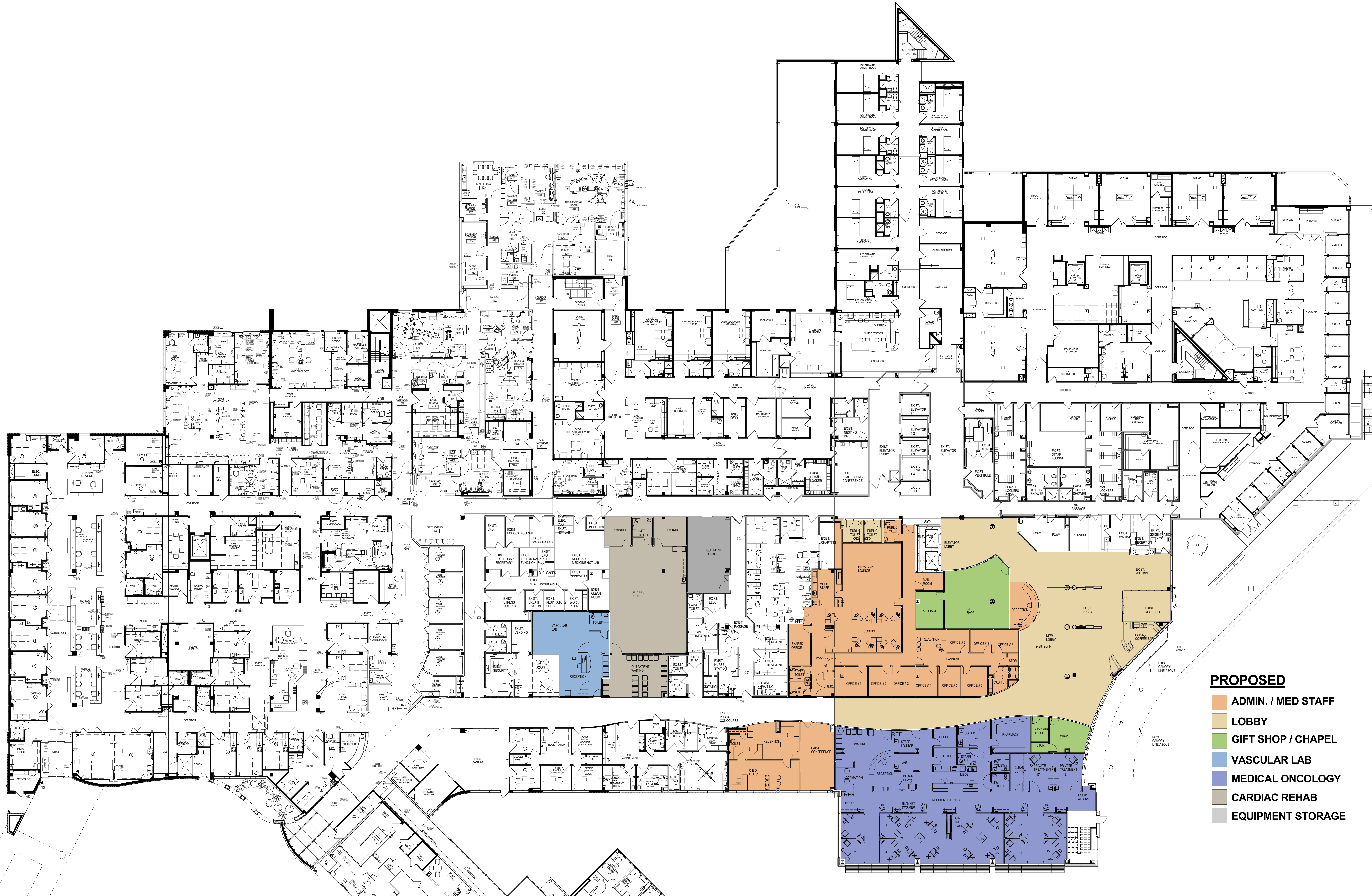

- PROPOSED**
- ADMIN. / MED STAFF
  - LOBBY
  - GIFT SHOP / CHAPEL
  - VASCULAR LAB
  - MEDICAL ONCOLOGY
  - CARDIAC REHAB
  - EQUIPMENT STORAGE

9/28/2015 9:07:51 AM C:\rev\1015\Calvert County - New Tower\_j.rvt